

■ TROUBLE SHOOTING

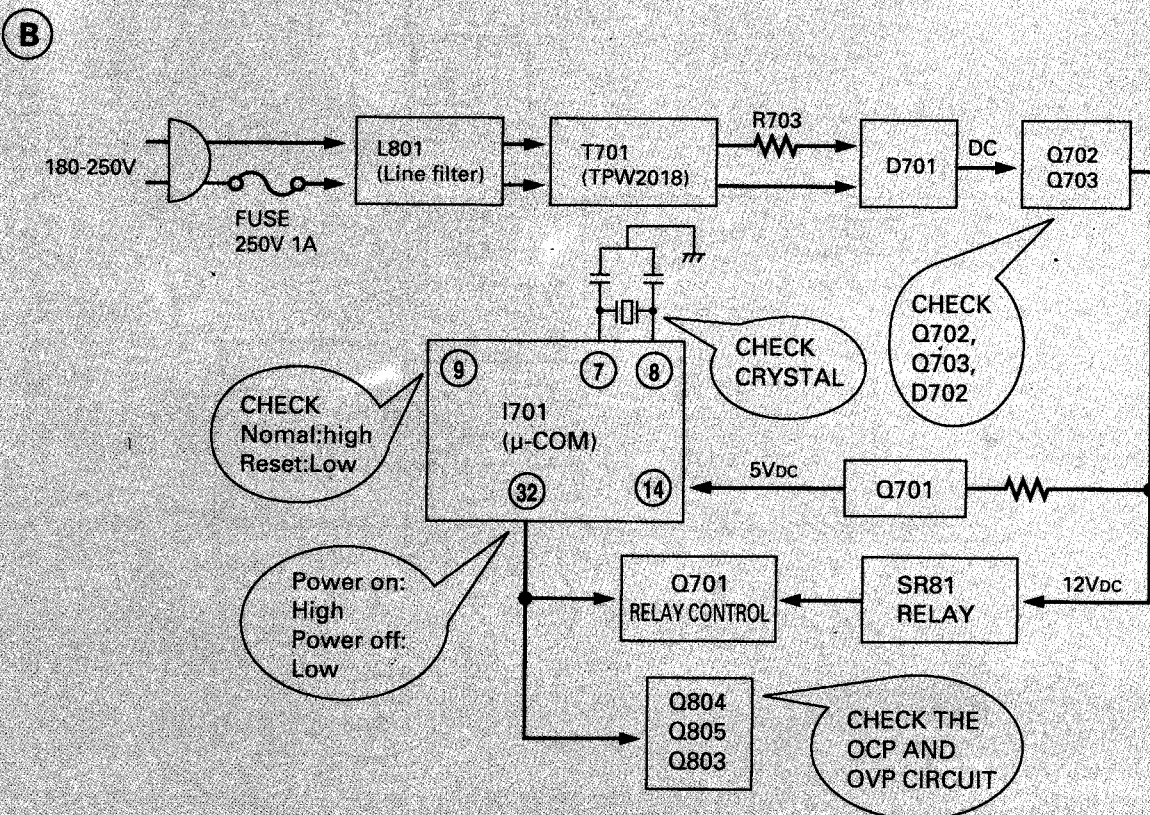

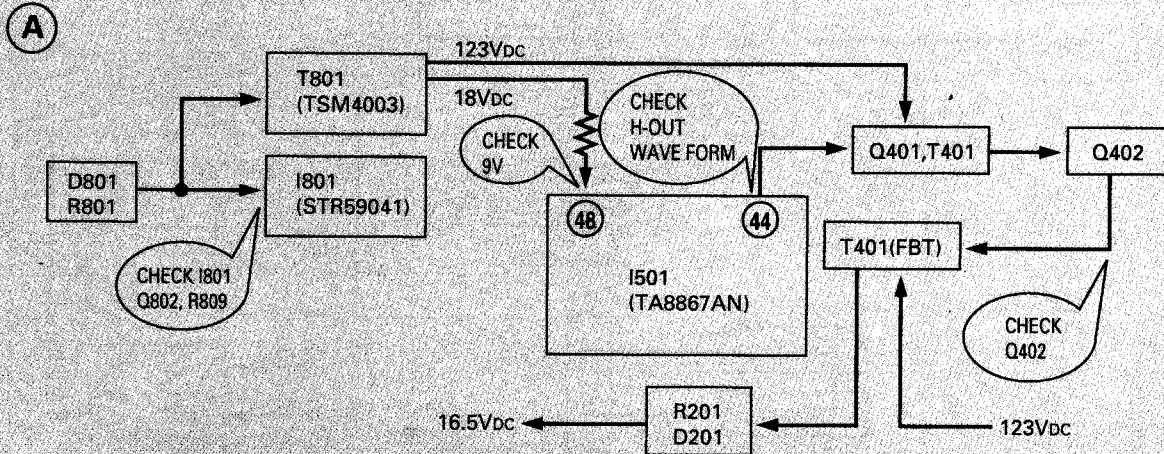

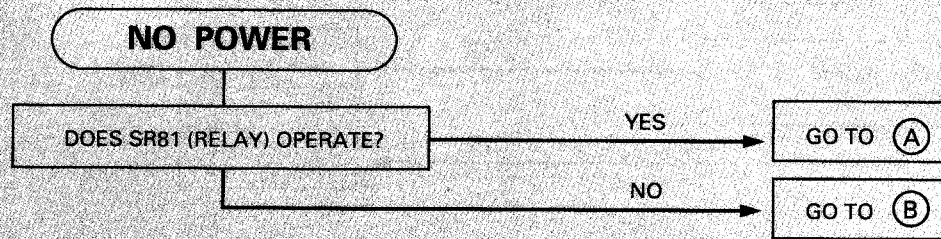
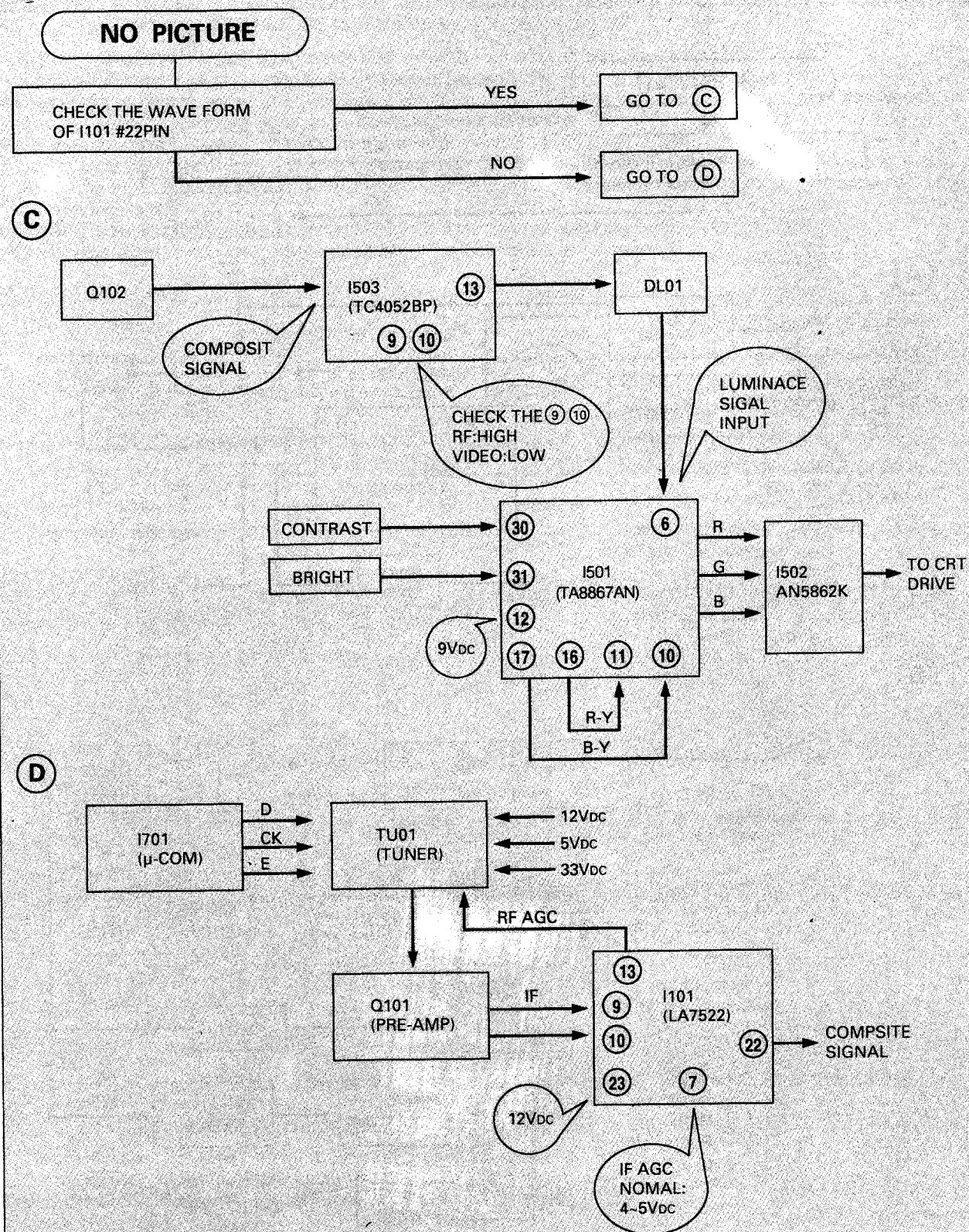
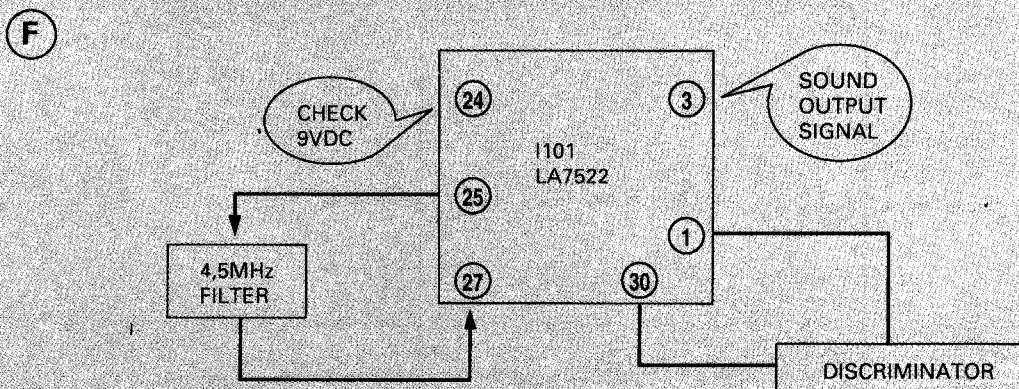
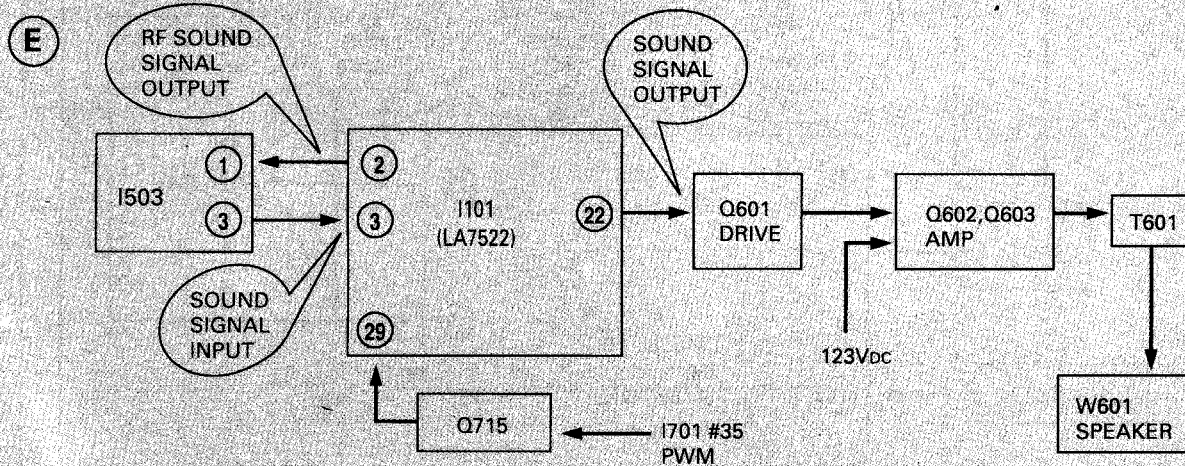
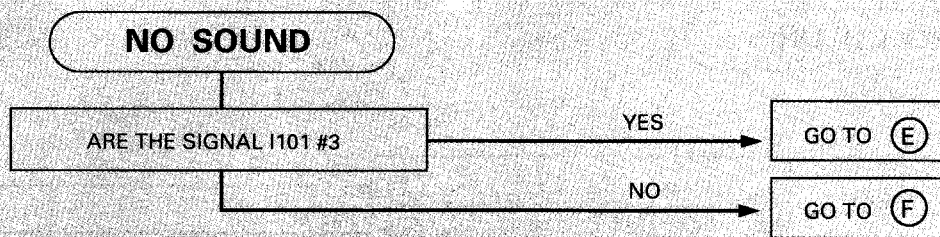

NO COLOR

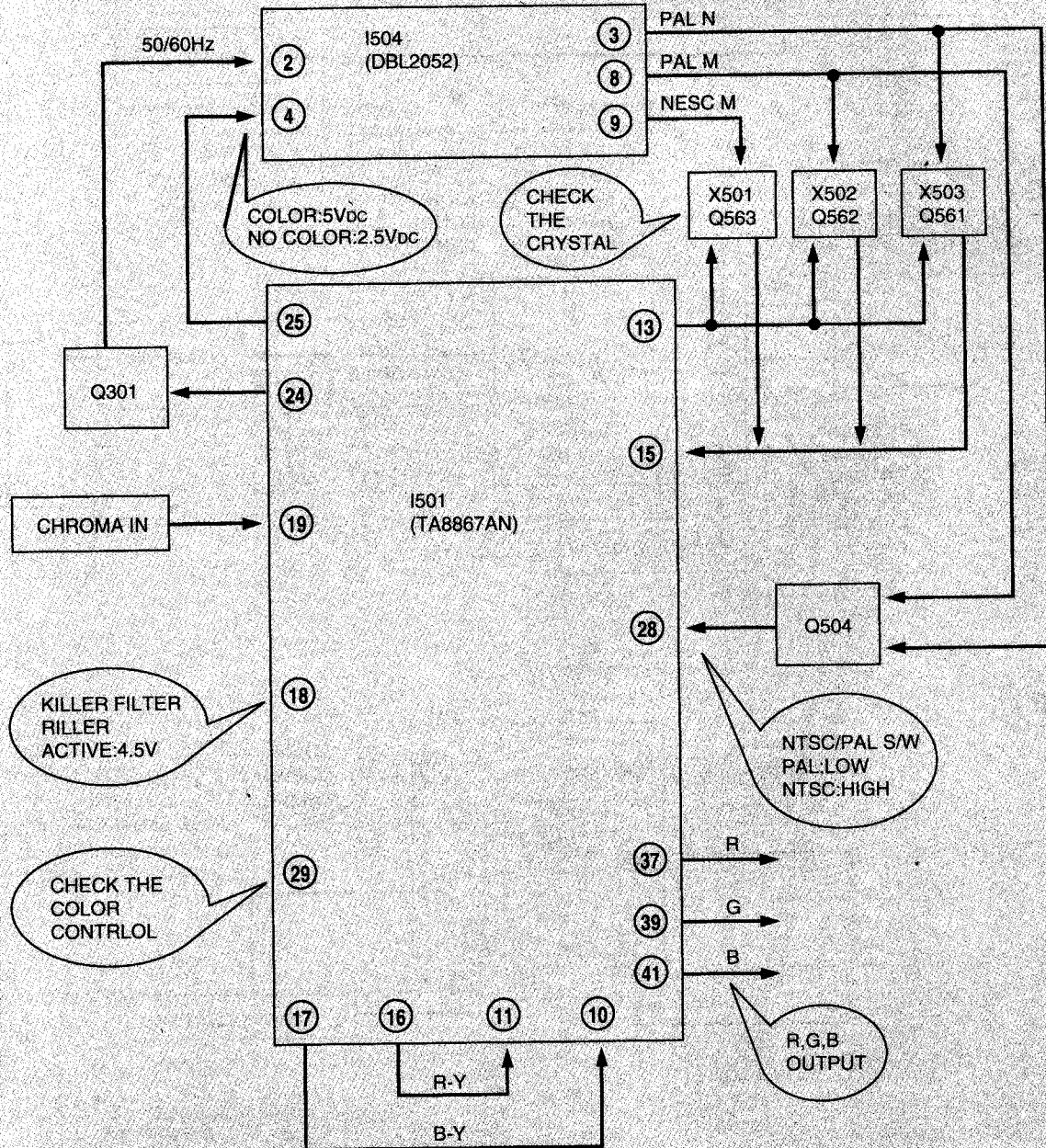

ON SCREEN DISPLAY DOES NOT OPERATE

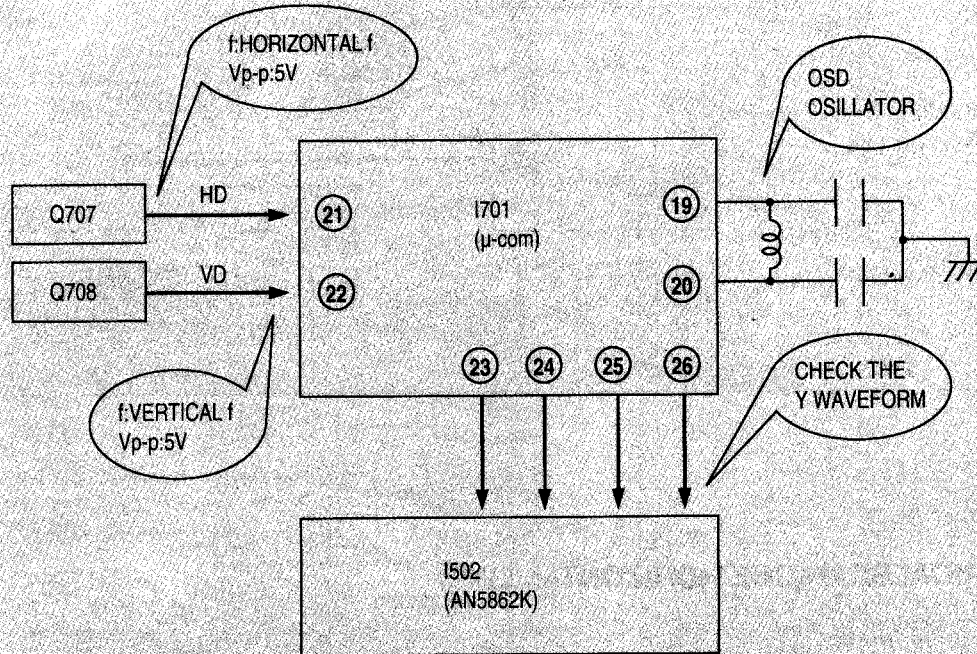

AV DOES NOT OPERATE

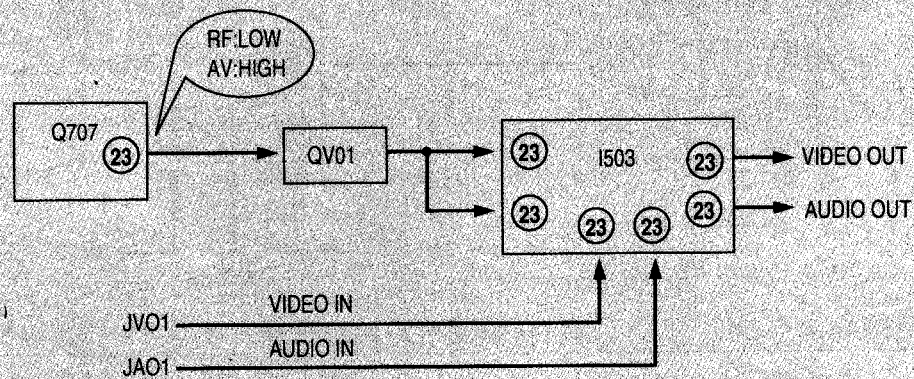

■ CHANNEL DON'T MEMORY (AUTO CHANNEL MEMORY)

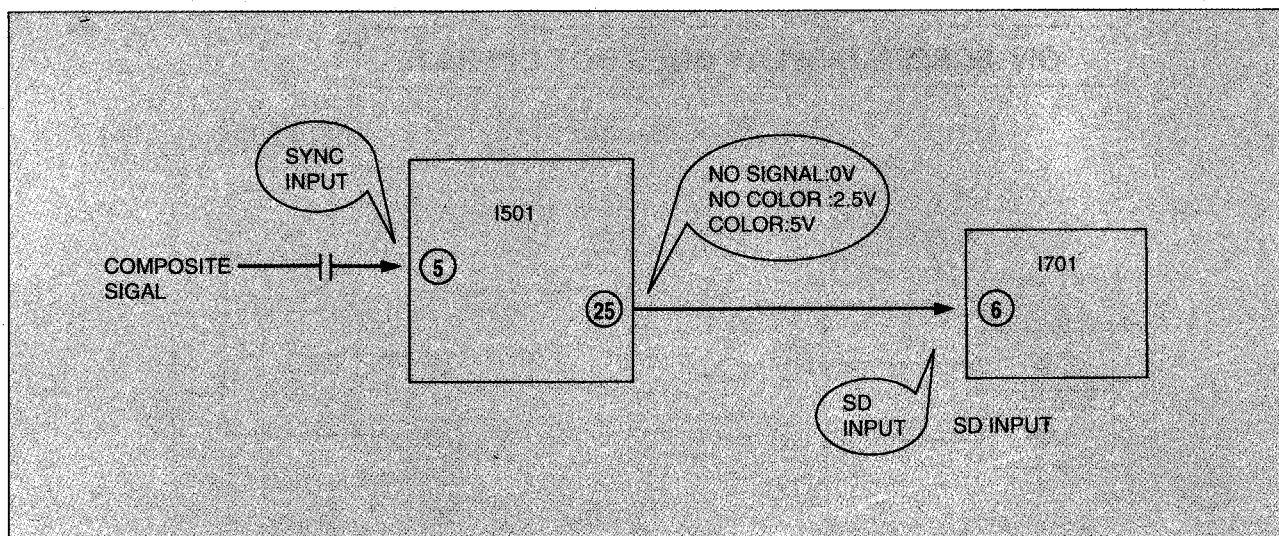

■ NO VERICALSCAN(ONE HORIZONTAL LINE)

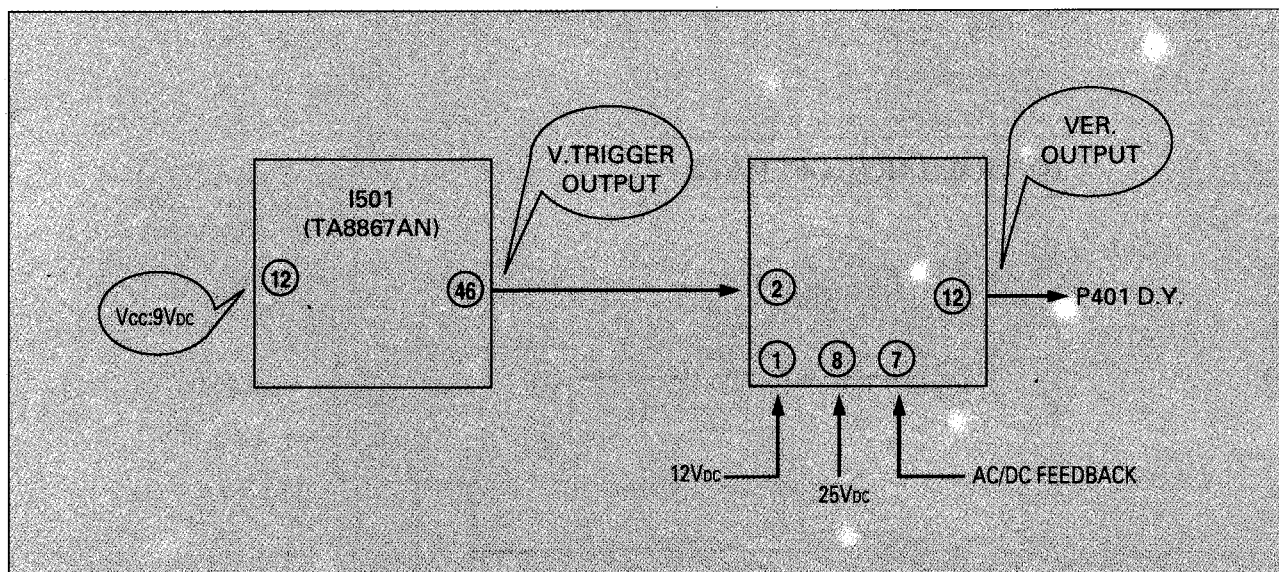

■ REPLACEMENT PARTS LIST

LOC.	PART-CODE	PART-NAME	PART-DESCRIPTION	REMARK
ZZ100	48B3018C26	T/ REMOCON	R-18C26	
IC01	1M50560388	IC REMOCON	M50560-388GP	
ZZ131	58G0000110	COIL DEGAUSSING	DC-2080	20"
ZZ131	58G0000084	COIL DEGAUSSING	DC-1450	14"
ZZ132	48519A5110	CRT GROUND AS	2001S-1015-1P	20"
ZZ132	48519A4710	CRT GROUND AS	1401S-1015-1P	14"
A001	4859805110	PCB LED	T1.6X33X29(203X141/6X4)	
DL01	DD1LARN---	LED	DS2 (DL-1LARN) RED	
DL02	DDL1LGN---	LED	DL-1LGN	
DL03	DD1LARN---	LED	DS2 (DL-1LARN) RED	
I704	1SR5HP----	IC PREAMP	SR-5HP	
JL01	85801065GY	WIRE COPPER	AWG22 1/0.65 TIN COATING	
M352	4853527501	HOLDER LED	HIPS BK	
M371	4853734900	RETA P-AMP	FR ABS BK	
PA701	4850706S01	CONN AS	YH025-06+YST025+ULW=200	
CRT1	4859604263	CRT	A48JLL91X02 M16	
M211B	7122401412	SCREW TAPPING	T2S TRS 4X14 MFZN BK	
M211C	7122401412	SCREW TAPPING	T2S TRS 4X14 MFZN BK	
M221A	7122401412	SCREW TAPPING	T2S TRS 4X14 MFZN BK	
M251	4852525800	GRILL SPKR	SECC T0.5	20"
M251	4852525700	GRILL SPKR	SECC T0.5	14"
M281	4852815601	DOOR	ABS BK	20"
M281	4852815501	DOOR	ABS BK	14"
M361	4853622600	TERMINAL ANT	FR HIPS BK CORE A	
M481	4854837604	BUTTON POWER	ABS BK	20"
M481	4854837504	BUTTON	ABS BK	14"
M481A	4856716000	SPRING	SWPA PIE0.5	
M491	4854916602	BUTTON	HG ABS BK	
M491A	7121301011	SCREW TAPPING	T2S PAN 3X10 MFZN	
M492	4854917401	BUTTON	ABS BK	
M492A	7121301011	SCREW TAPPING	T2S PAN 3X10 MFZN	
M501	4855050527	DECO CTRL	PVC T0.2	20"
M501	4855050527	DECO CTRL	PVC T0.2	14"
M551	4855519300	DECO SENSOR	P.C SMOG	20"
M551	4855519204	DECO SENSOR	PC	14"
M561	4855615900	MARK BRAND	A1050P-H24 T0.4	20"
M561	4855613600	MARK BRAND	COPPER T0.4	14"
M621	4856013300	SCREW CRT FIXING AS	30X70 BK	
M622	4856215402	WASHER RUBBER	CR	
M623	4856013301	SCREW CRT FIXING AS	30X140 YL	
M681	4856816300	CLAMP WIRE	NYLON 6 (V0)	
M791	4857923300	DOOR LOCK	LA701(KIFCO)	
SP01A	7128301011	SCREW TAPPING	T2S WAS 3X10 MFZN	
M201	4852047401	MASK FRONT	HIPS BK	20"
M201	4852047301	MASK FRONT	HIPS BK	14"
M331	4853311601	RETAINER BACK	HIPS NC	
P004A	4850703028	CONN AS	YH025-03+YST025+USW=200	
SP01	4858305220	SPEAKER	3W 8 OHM MSF-2D30SB02U	
ASB1	4850A18140	ANT SHIELD BOX	S-701F=200	
C403	CMXM2A474J	C MYLAR	100V 0.47MF J	
C410	CMYB2D334J	C MYLARP	200V EU 0.33MF J	14"
C410	CMYB2D394J	C MYLAR	200V EU 0.39MF J	20"
C414	CMYH3C622J	C MYLAR	P 1.6KV BUP 6200PF J	14"
C414	CMYH3C752J	C MYLAR	1.6KV BUP 7500PF J	20"
C527	CMXM2A224J	C MYLAR	100V 0.22MF J	
C801	CLYL2E104M	C LINE ACROSS	250V 0.1MF M S,D,V	
C803	CCYB3A472K	C CERA	1KV B 4700PF K	
C804	CCYB3A472K	C CERA	1KV B 4700PF K	
C805	CCYB3A472K	C CERA	1KV B 4700PF K	
C806	CCYB3A472K	C CERA	1KV B 4700PF K	
C807	CEYN2W151P	C ELECTRO	450V LHS 150MF (25X40)	
C811	CMYE2J333J	C MYLAR	630V PU 0.033MF J	

LOC.	PART-CODE	PART-NAME	PART-DESCRIPTION	REMARK
C814	CH1BEE472M	C CERA AC	U/C/V 2.5KV SDE2G472M20BS	14" 20"
C816	CH1BEE472M	C CERA AC	U/C/V 2.5KV SDE2G472M20BS	
C818	DSVC471D14	VARISTOR	SVC471D14A	
C822	CH1BFE222M	C CERA AC	U/C/V AC400V 2200PF	
C826	CH1BFE222M	C CERA AC	U/C/V AC400V 2200PF	
D701	DS1VB20---	DIODE BRIDGE	S1VB20	
D801	DBYW95C---	DIODE	BYW95C (TAPPING)	
D810	DPBS408GU-	DIODE	PBS408GU-CA	
DL01	58Q3580047	COIL DELAY LINE	B040358T 3.58MHZ	
F801	5FSGB3122L	FUSE GLASS TUBE	SEMKO MF51 3.15A 250V TL	
I101	1LA7522---	IC	LA7522	
I133	1UPC574J--	IC	UPC574J	
I201	1MC7812---	IC REGULATOR	MC7812 12V 1A (KA7812)	
I201A	4857025200	HEAT SINK	SPCC T1.0 DG	
I201B	7174300811	SCREW TAPPTITE	TT2 RND 3X8 MFZN	
I201D	4856215200	WASHER	SPCC	
I202	1KA7809---	IC REGULATOR	KA7809	
I202A	4857013300	HEAT SINK C	SPCC T1.0 SN-3	
I202B	7174300811	SCREW TAPPTITE	TT2 RND 3X8 MFZN	
I202D	4856215200	WASHER	SPCC	
I301	1LA7837---	IC	LA7837	
I301A	4857024602	HEAT SINK	AL EX (2160AS)	
I301B	7174300811	SCREW TAPPTITE	TT2 RND 3X8 MFZN	
I501	1TA8867AN-	IC	TA8867AN	
I503	1TC4052BP-	IC	TC4052BP	
I504	1DBL2052--	IC SWITCH	DBL2052	
I701	1Z86221480	IC MICOM	Z86227-1480	
I702	1AT93C46PC	IC EEPROM	AT93C46-10PC	
I801	1STR59041-	IC	STR59041	
I801A	4857026500	HEAT SINK	AL EX	
I801B	7174301011	SCREW TAPPTITE	TT2 RND 3X10 MFZN	
JV01	4859103450	JACK PIN BOARD	YSC02P-2400-13A (12.5MM)	
L106	58B4500047	COIL PIF	TRF-4547	
L107	58C5580019	COIL CHOKE	TRF-9225 (0.55UH)	
L401	58H0000018	COIL H-LINEARITY	P L-125 (125UH)	
L401	58H0000020	COIL H-LINEARITY	L-76(76.5UH)	
L507	58Q3570048	COIL DELAY LINE	SD-11P1CM-A	
L508	58Q3R58051	COIL DELAY LINE	SD-11 P1CN-A	
L801	5PTLF106--	FILTER LINE	TLF-106	
L841	58C0000107	COIL CHOKE	L-680	
M351	4853514400	STOPPER CORD	FR P.P BLACK	
M791	4857913304	RUBBER CUSHION	FR RUBBER SPONGE	
M792	4857913304	RUBBER CUSHION	FR RUBBER SPONGE	
P401	4859240020	CONN WAFER	YFW500-05	
P801	4859242220	CONN WAFER	YFW800-02	
P803	4859242220	CONN WAFER	YFW800-02	
PA702	4850705N07	CONN AS	BIC-05T-25T+ULW=200	
PA703	4850706N03	CONN AS	BIC-06T-25T+ULW=200	
PA802	4850702S09	CONN AS	BL102NG+MXH40058-02=300	
PA950	4850705036	CONN AS	GIL-J-5P+GIL10000+ULW=500	
PA980	4850703239	CONN AS	YBH025-03+YBIT025+ULW=350	
PWC1	4859904210	CORD POWER AS	WSP-93 250V 7.5A L=2600	
A0000	4859905011	CORD POWER	WSP-93 7.5A 250V 2.6M	
Q402	TKSD5071Y-	TR	P KSD5071Y	14" 20"
Q402	TKSD5072TU	TR	KSD5072-TU	
Q402A	4857024500	HEAT SINK	AL EX B/K	
Q402B	7174301011	SCREW TAPPTITE	TT2 RND 3X10 MFZN	
Q402D	4856215201	WASHER	SPCC	
Q602	TKTA940---	TR	KTA940	
Q602A	4857025200	HEAT SINK	SPCC T1.0 DG	
Q602B	7174300811	SCREW TAPPTITE	TT2 RND 3X8 MFZN	
Q602D	4856215200	WASHER	SPCC	

LOC.	PART-CODE	PART-NAME	PART-DESCRIPTION	REMARK
Q603	TKTC2073--	TR	KTC2073	
Q603A	4857025200	HEAT SINK	SPCC T1.0 DG	
Q603B	7174300811	SCREW TAPPTITE	TT2 RND 3X8 MFZN	
Q603D	4856215200	WASHER	SPCC	
Q701	1KA7805---	IC REGULATOR	KA7805	
Q702	TKTD2058Y-	TR	KTD 2058-Y	
Q702A	4857013300	HEAT SINK C	SPCC T1.0 SN-3	
Q702B	7174300811	SCREW TAPPTITE	TT2 RND 3X8 MFZN	
Q702D	4856215200	WASHER	SPCC	
Q950	TKTC3229--	TR	KTC 3229	
Q951	TKTC3229--	TR	KTC 3229	
Q952	TKTC3229--	TR	KTC 3229	
R801	RX10B479JK	R CEMENT	10W 4.7 OHM J (PCB 25MM)	
R807	RX07B300JN	R CEMENT	7W 30 OHM J BENCH 4P	
R830	DJ140M290L	POSISTOR	J503P53D140M290L	
R941	RV5221103-	R SEMI FIXED	V10K-5X2.5-6Y-PC-RP	
R942	RV5221201-	R SEMI FIXED	EVN D2A A03 200 OHM B	
R943	RV5221103-	R SEMI FIXED	V10K-5X2.5-6Y-PC-RP	
R944	RV5221201-	R SEMI FIXED	EVN D2A A03 200 OHM B	
R945	RV5221103-	R SEMI FIXED	V10K-5X2.5-6Y-PC-RP	
RLY1	5SC0101328	SW RELAY	SDT-SS-112DM	
SCT1	4859302530	SOCKET CRT	ISM-03S	
SW301	5S40403035	SW LEVER	JRS-1301	
SW701	5S50101008	SW TACT	KPT-1105V 1C-1P	
SW702	5S50202002	SW TACT	JTM-1108B 2C-2P	
SW703	5S50202002	SW TACT	JTM-1108B 2C-2P	
SW704	5S50101008	SW TACT	KPT-1105V 1C-1P	
SW705	5S50202002	SW TACT	JTM-1108B 2C-2P	
SW706	5S50202002	SW TACT	JTM-1108B 2C-2P	
SW801	5S40102073	SW PUSH	ME-7 1C 2P (70062-220)	
T401	50D0000022	TRANS DRIVE	HD-15D	
T401A	4857234100	SHIELD PLATE	SPTH-C T0.3	
T402	50H0000129	FBT	DCF-2077Z	
T601	5T0U000005	TRANS SOUND OUTPUT	TSP-1036	
T701	50P0000191	TRANS POWER	TPW-2010	
T801	50M0000053	TRANS SMPS	TSM-4003	
U001	4859712730	TUNER VARACTOR	VTSH7USZFD1	
X401	4850L02310	RESONATOR CERA	CSB503F30	
X502	5XE3R5756C	CRYSTAL QUARTZ	HC-49/U 3.575611MHZ 20PPM	
Z104	5PDSW1003S	FILTER SAW	DSW 1003S	
C134	CEXF1C102V	C ELECTRO	16V RSS 1000MF (10X20) TP	
C201	CEXF1E102V	C ELECTRO	25V RSS 1000MF (13X20) TP	
C203	CEXF1C102V	C ELECTRO	16V RSS 1000MF (10X20) TP	
C302	CEXF1V102V	C ELECTRO	35V RSS 1000MF (13X25) TP	
C303	CTXD1V109K	C TANTAL	35V 1MF K (TAPPING)	
C305	CMXL1H105J	C MYLAR	50V MEU 1MF J	
C308	CEXF1V471V	C ELECTRO	35V RSS 470MF (10X20) TP	
C415	CCXB3D271K	C CERA	2KV B 270PF K (T)	
C517	CMXL1H105J	C MYLAR	50V MEU 1MF J	
C610	CEXF2C479V	C ELECTRO	160V RSS 4.7MF (8X16) TP	
C612	CEXF2C101V	C ELECTRO	160V RSS 100MF (16X25) TP	
C701	CEXF1H471V	C ELECTRO	50V RSS 470MF (13X20) TP	
C702	CEXF1C102V	C ELECTRO	16V RSS 1000MF (10X20) TP	
C710	CEXF1C102V	C ELECTRO	16V RSS 1000MF (10X20) TP	
C808	CEXF2A470C	C ELECTRO	100V RUS 47MF (10X16) TP	
C812	CCXB3A102K	C CERA	1KV B 1000PF K (TAPPING)	
C815	CEXF2C330V	C ELECTRO	160V RSS 33MF (13X20) TP	
C819	CCXB3A102K	C CERA	1KV B 1000PF K (TAPPING)	
C841	CEXF2C101C	C ELECTRO	160V RUS 100MF (16X25) TP	
C842	CCXB3D102K	C CERA	2KV B 1000PF K (TAPPING)	
C843	CEXF2E479V	C ELECTRO	250V RSS 4.7MF (10X16)TP	
C845	CEXF2C330C	C ELECTRO	160V RUS 33MF (13X20) TP	

LOC.	PART-CODE	PART-NAME	PART-DESCRIPTION	REMARK
C847	CEXF1V471V	C ELECTRO	35V RSS 470MF (10X20) TP	
C849	CCXB3A331K	C CERA	1KV B 330PF K (TAPPING)	
C951	CCXB3D102K	C CERA	2KV B 1000PF K (TAPPING)	
Q801	T2SD1207T-	TR	2SD1207-T (TAPPING)	
Q802	T2SD1207T-	TR	2SD1207-T (TAPPING)	
Q803	TKSA1013Y-	TR	KSA1013Y (TP)	
Z101	5PXPS45MB-	FILTER CERA	TPS-4.5MB TRAP (TAPPING)	
Z102	5PXFSH4R5M	FILTER CERA	SFSH4.5MCB-TF21 TAPING	
Z103	5PXDA45MC-	FILTER CERA	CDA 4.5MC 10 (TAPPING)	
L103	58B25R2S60	COIL PIF	TRF-0082(STICK)	
L104	58S4100S17	COIL SIF	TRF-4182(41.25MHZ)STICK	
L105	58E45R7S17	COIL AFT	TRF-4568(45.75MHZ)STICK	
L402	58C0000026	COIL BEAD	HC-4035	
L805	58C0000026	COIL BEAD	HC-4035	
L806	58C0000026	COIL BEAD	HC-4035	
P101	485923162S	CONN WAFER	YW025-03 (STICK)	
P601	485923162S	CONN WAFER	YW025-03 (STICK)	
P701	485923192S	CONN WAFER	YW025-06 (STICK)	
P804	485923162S	CONN WAFER	YW025-03 (STICK)	
R130	RS02Z151J-	R M-OXIDE FILM	2W 150 OHM J (TAPPING)	
R132	RS02Z183J-	R M-OXIDE FILM	2W 18K OHM J (TAPPING)	
R201	RF02Z229J-	R FUSIBLE	2W 2.2 OHM J (TAPPING)	
R203	RS01Z560J-	R M-OXIDE FILM	1W 56 OHM J (TAPPING)	
R204	RS02Z680J-	R M-OXIDE FILM	2W 68 OHM J (TAPPING)	
R205	RS01Z560J-	R M-OXIDE FILM	1W 56 OHM J (TAPPING)	
R307	RS01Z331J-	R M-OXIDE FILM	1W 330 OHM J (TAPPING)	
R309	RS01Z229J-	R M-OXIDE FILM	1W 2.2 OHM J (TAPPING)	
R315	RF01Z309J-	R FUSIBLE	1W 3 OHM J (TAPPING)	
R404	RS01Z331J-	R M-OXIDE FILM	1W 330 OHM J (TAPPING)	
R405	RS02Z153J-	R M-OXIDE FILM	2W 15K OHM J (TAPPING)	
R406	RS02Z153J-	R M-OXIDE FILM	2W 15K OHM J (TAPPING)	
R410	RS01Z182J-	R M-OXIDE FILM	1W 1.8K OHM J (TAPPING)	
R419	RS02Z153J-	R M-OXIDE FILM	2W 15K OHM J (TAPPING)	
R611	RS01Z121J-	R M-OXIDE FILM	1W 120 OHM J (TAPPING)	
R702	RS01Z101J-	R M-OXIDE FILM	1W 100 OHM J (TAPPING)	
R703	RS01Z229J-	R M-OXIDE FILM	1W 2.2 OHM J (TAPPING)	
R804	RS01Z561J-	R M-OXIDE FILM	1W 560 OHM J (TAPPING)	
R805	RS02Z560J-	R M-OXIDE FILM	2W 56 OHM J (TAPPING)	
R806	RS01Z561J-	R M-OXIDE FILM	1W 560 OHM J (TAPPING)	
R809	RF02Z278J-	R FUSIBLE	2W 0.27 OHM J (TAPPING)	
R811	RS01Z829J-	R M-OXIDE FILM	1W 8.2 OHM J (TAPPING)	
R813	RS02Z623J-	R M-OXIDE FILM	2W 62K OHM J (TAPPING)	
R840	RS01Z393J-	R M-OXIDE FILM	1W 39K OHM J (TAPPING)	
R841	RF01Z519J-	R FUSIBLE	1W 5.1 OHM J (TAPPING)	
R842	RF02Z100J-	R FUSIBLE	2W 10 OHM J (TAPPING)	
R844	RF01Z688J-	R FUSIBLE	1W 0.68 OHM J (TAPPING)	
R951	RS02Z123J-	R M-OXIDE FILM	2W 12K OHM J (TAPPING)	
R952	RS02Z123J-	R M-OXIDE FILM	2W 12K OHM J (TAPPING)	
R953	RS02Z123J-	R M-OXIDE FILM	2W 12K OHM J (TAPPING)	
C106	CMXM2A683J	C MYLAR	100V 0.068MF J (TP)	
C109	CEXF1H478V	C ELECTRO	50V RSS 0.47MF (5X11) TP	
C118	CEXF1E330V	C ELECTRO	25V RSS 33MF (5X11) TP	
C119	CEXF1H479V	C ELECTRO	50V RSS 4.7MF (5X11) TP	
C120	CEXF1H100V	C ELECTRO	50V RSS 10MF (5X11) TP	
C121	CEXF1H100V	C ELECTRO	50V RSS 10MF (5X11) TP	
C122	CEXF1H100V	C ELECTRO	50V RSS 10MF (5X11) TP	
C123	CMXM2A153J	C MYLAR	100V 0.015MF J (TP)	
C131	CEXF1E221V	C ELECTRO	25V RSS 220MF (8X11.5) TP	
C133	CEXF1H109V	C ELECTRO	50V RSS 1MF (5X11) TP	
C135	CEXF1C221V	C ELECTRO	16V RSS 220MF (8X11.5) TP	
C202	CCXB2H102K	C CERA	500V B 1000PF K (TAPPING)	
C301	CXCH1H100D	C CERA	50V CH 10PF D (TAPPING)	

LOC.	PART-CODE	PART-NAME	PART-DESCRIPTION	REMARK
C304	CEXF1H101V	C ELECTRO	50V RSS 100MF (8X11.5) TP	
C306	CMXM2A103J	C MYLAR	100V 0.01MF J (TP)	
C307	CCXB2H102K	C CERA	500V B 1000PF K (TAPPING)	
C310	CMXM2A104J	C MYLAR	100V 0.1MF J (TP)	
C401	CEXF1E101V	C ELECTRO	25V RSS 100MF (6.3X11) TP	
C402	CEXF1H478V	C ELECTRO	50V RSS 0.47MF (5X11) TP	
C404	CEXE2C229C	C ELECTRO	160V RU 2.2MF (8X11.5) TP	
C406	CEXF1H109V	C ELECTRO	50V RSS 1MF (5X11) TP	
C407	CMXM2A223J	C MYLAR	100V 0.022MF J (TP)	
C408	CMXM2A392J	C MYLAR	100V 3900PF J (TP)	
C412	CMXM2A104J	C MYLAR	100V 0.1MF J (TP)	
C430	CCXB2H102K	C CERA	500V B 1000PF K (TAPPING)	
C507	CEXF1H479V	C ELECTRO	50V RSS 4.7MF (5X11) TP	
C508	CEXF1H479V	C ELECTRO	50V RSS 4.7MF (5X11) TP	
C509	CEXF1H479V	C ELECTRO	50V RSS 4.7MF (5X11) TP	
C510	CMXM2A104J	C MYLAR	100V 0.1MF J (TP)	
C513	CEXF1H109V	C ELECTRO	50V RSS 1MF (5X11) TP	
C514	CEXF1H109V	C ELECTRO	50V RSS 1MF (5X11) TP	
C516	CMXM2A103J	C MYLAR	100V 0.01MF J (TP)	
C525	CEXF1H109V	C ELECTRO	50V RSS 1MF (5X11) TP	
C526	CMXM2A104J	C MYLAR	100V 0.1MF J (TP)	
C531	CMXM2A104J	C MYLAR	100V 0.1MF J (TP)	
C532	CMXM2A104J	C MYLAR	100V 0.1MF J (TP)	
C533	CMXM2A104J	C MYLAR	100V 0.1MF J (TP)	
C534	CEXF1H100V	C ELECTRO	50V RSS 10MF (5X11) TP	
C543	CEXF1E470V	C ELECTRO	25V RSS 47MF (5X11) TP	
C544	CEXF1H100V	C ELECTRO	50V RSS 10MF (5X11) TP	
C559	CEXF1H479V	C ELECTRO	50V RSS 4.7MF (5X11) TP	
C574	CEXF1E470V	C ELECTRO	25V RSS 47MF (5X11) TP	
C609	CXSL2H470J	C CERA	500V SL 47PF J (TAPPING)	
C611	CCXB2H102K	C CERA	500V B 1000PF K (TAPPING)	
C615	CEXF1H100V	C ELECTRO	50V RSS 10MF (5X11) TP	
C704	CMXM2A104J	C MYLAR	100V 0.1MF J (TP)	
C711	CEXF1H100V	C ELECTRO	50V RSS 10MF (5X11) TP	
C712	CEXF1H100V	C ELECTRO	50V RSS 10MF (5X11) TP	
C713	CEXF1H109V	C ELECTRO	50V RSS 1MF (5X11) TP	
C714	CEXF1H100V	C ELECTRO	50V RSS 10MF (5X11) TP	
C715	CEXF1H100V	C ELECTRO	50V RSS 10MF (5X11) TP	
C716	CEXF1H100V	C ELECTRO	50V RSS 10MF (5X11) TP	
C717	CEXF1H479V	C ELECTRO	50V RSS 4.7MF (5X11) TP	
C718	CEXF1E470V	C ELECTRO	25V RSS 47MF (5X11) TP	
C720	CEXF1H100V	C ELECTRO	50V RSS 10MF (5X11) TP	
C722	CEXF1C331V	C ELECTRO	16V RSS 330MF (8X11.5) TP	
C723	CEXF1H220V	C ELECTRO	50V RSS 22MF (5X11) TP	
C809	CMXM2A223J	C MYLAR	100V 0.022MF J (TP)	
C810	CEXF2A100V	C ELECTRO	100V RSS 10MF (6.3X11) TP	
C813	CMXM2A104J	C MYLAR	100V 0.1MF J (TP)	
C820	CEXF1H100V	C ELECTRO	50V RSS 10MF (5X11) TP	
C823	CEXF1H100V	C ELECTRO	50V RSS 10MF (5X11) TP	
C844	CCXB2H102K	C CERA	500V B 1000PF K (TAPPING)	
C846	CEXF1E101V	C ELECTRO	25V RSS 100MF (6.3X11) TP	
C952	CEXF1H100V	C ELECTRO	50V RSS 10MF (5X11) TP	
CA02	CEXF1H109V	C ELECTRO	50V RSS 1MF (5X11) TP	
CV01	CEXF1H100V	C ELECTRO	50V RSS 10MF (5X11) TP	
CV04	CEXF1H100V	C ELECTRO	50V RSS 10MF (5X11) TP	
F801A	4857415001	CLIP FUSE	PFC5000-0702	
F801B	4857415001	CLIP FUSE	PFC5000-0702	
L951	5CPX220J--	COIL PEAKING	22UH J (RADIAL)	
Q101	TKTC3197--	TR	KTC3197 (TP)	
Q102	TKSC945CY-	TR	KSC 945C-Y (TAPPING)	
Q103	TKSC945CY-	TR	KSC 945C-Y (TAPPING)	
Q301	TKSC945CY-	TR	KSC 945C-Y (TAPPING)	

LOC.	PART-CODE	PART-NAME	PART-DESCRIPTION	REMARK
Q401	TKTC3207--	TR	KTC3207 (TP)	
Q501	TKSC945CY-	TR	KSC 945C-Y (TAPPING)	
Q502	TKSC945CY-	TR	KSC 945C-Y (TAPPING)	
Q504	TKSC945CY-	TR	KSC 945C-Y (TAPPING)	
Q505	TKSC945CY-	TR	KSC 945C-Y (TAPPING)	
Q506	TKSC945CY-	TR	KSC 945C-Y (TAPPING)	
Q561	TKSC945CY-	TR	KSC 945C-Y (TAPPING)	
Q562	TKSC945CY-	TR	KSC 945C-Y (TAPPING)	
Q563	TKSC945CY-	TR	KSC 945C-Y (TAPPING)	
Q601	TKTC1026Y-	TR	KTC1026Y (TP)	
Q703	TKSA733CY-	TR	KSA733CY (TP)	
Q704	TKSA733CY-	TR	KSA733CY (TP)	
Q705	TKSC945CY-	TR	KSC 945C-Y (TAPPING)	
Q706	TKSC945CY-	TR	KSC 945C-Y (TAPPING)	
Q707	TKSC945CY-	TR	KSC 945C-Y (TAPPING)	
Q708	TKSC945CY-	TR	KSC 945C-Y (TAPPING)	
Q709	TKSC945CY-	TR	KSC 945C-Y (TAPPING)	
Q710	TKTC3203Y-	TR	KTC3203-Y	
Q715	TKSA733CY-	TR	KSA733CY (TP)	
Q720	TKSC945CY-	TR	KSC 945C-Y (TAPPING)	
Q804	TKSA733CY-	TR	KSA733CY (TP)	
Q805	TKSC945CY-	TR	KSC 945C-Y (TAPPING)	
QV01	TKSC945CY-	TR	KSC 945C-Y (TAPPING)	
QV02	TKSC945CY-	TR	KSC 945C-Y (TAPPING)	
QV03	TKSA733CY-	TR	KSA733CY (TP)	
QV04	TKSA733CY-	TR	KSA733CY (TP)	
R100	RV5426103P	R SEMI FIXED	RH0638C 10K OHM B	
R300	RV5426472P	R SEMI FIXED	RH0638C 4.7K OHM B	
R350	RV5426473P	R SEMI FIXED	RH0638C 47K OHM B	
R400	RV5426104P	R SEMI FIXED	EVN-DJA A03 100K OHM B	
R500	RV5426103P	R SEMI FIXED	RH0638C 10K OHM B	
X501	5XEX3R579C	CRYSTAL QUARTZ	HC-49U 3.579545M (TP)	
X503	5XEX3R582C	CRYSTAL QUARTZ	HC-49U 3.582056M 20PPM TA	
X701	5XEX4R000C	CRYSTAL QUARTZ	HC-49U 4.0000MHZ (TP)	
A001	4859801596	PCB MAIN	330X246 S1B	
C101	CCZF1E103Z	C CERA	25V F 0.01MF Z (AXIAL)	
C102	CCZF1E103Z	C CERA	25V F 0.01MF Z (AXIAL)	
C103	CCZF1E103Z	C CERA	25V F 0.01MF Z (AXIAL)	
C104	CCZF1E103Z	C CERA	25V F 0.01MF Z (AXIAL)	
C105	CCZF1E103Z	C CERA	25V F 0.01MF Z (AXIAL)	
C107	CCZF1E103Z	C CERA	25V F 0.01MF Z (AXIAL)	
C108	CCZF1E103Z	C CERA	25V F 0.01MF Z (AXIAL)	
C110	CCZF1E103Z	C CERA	25V F 0.01MF Z (AXIAL)	
C111	CZSL1H479K	C CERA	50V SL 4.7PF K (AXIAL)	
C112	CZCH1H120J	C CERA	50V CH 12PF J (AXIAL)	
C113	CBZR1C472M	C CERA	16V Y5R 4700PF M (AXIAL)	
C114	CBZR1C472M	C CERA	16V Y5R 4700PF M (AXIAL)	
C115	CZSL1H240J	C CERA	50V SL 24PF J (AXIAL)	
C116	CZSL1H300J	C CERA	50V SL 30PF J (AXIAL)	
C117	CZSL1H300J	C CERA	50V SL 30PF J (AXIAL)	
C124	CZSL1H300J	C CERA	50V SL 30PF J (AXIAL)	
C405	CBZF1H104Z	C CERA SEMI	50V F 0.1MF Z (AXIAL)	
C502	CCZF1E103Z	C CERA	25V F 0.01MF Z (AXIAL)	
C511	CCZF1E103Z	C CERA	25V F 0.01MF Z (AXIAL)	
C512	CCZF1E103Z	C CERA	25V F 0.01MF Z (AXIAL)	
C515	CZSL1H470J	C CERA	50V SL 47PF J (AXIAL)	
C524	CZSL1H390J	C CERA	50V SL 39PF J (AXIAL)	
C528	CCZF1E103Z	C CERA	25V F 0.01MF Z (AXIAL)	
C529	CCZF1E103Z	C CERA	25V F 0.01MF Z (AXIAL)	
C530	CCZF1E103Z	C CERA	25V F 0.01MF Z (AXIAL)	
C535	CCZF1E103Z	C CERA	25V F 0.01MF Z (AXIAL)	
C536	CCZF1E103Z	C CERA	25V F 0.01MF Z (AXIAL)	

LOC.	PART-CODE	PART-NAME	PART-DESCRIPTION	REMARK
C537	CCZF1E103Z	C CERA	25V F 0.01MF Z (AXIAL)	
C538	CCZF1E103Z	C CERA	25V F 0.01MF Z (AXIAL)	
C539	CCZF1E103Z	C CERA	25V F 0.01MF Z (AXIAL)	
C540	CBZF1H104Z	C CERA SEMI	50V F 0.1MF Z (AXIAL)	
C541	CCZF1E103Z	C CERA	25V F 0.01MF Z (AXIAL)	
C542	CCZF1E103Z	C CERA	25V F 0.01MF Z (AXIAL)	
C545	CZSL1H300J	C CERA	50V SL 30PF J (AXIAL)	
C546	CZSL1H300J	C CERA	50V SL 30PF J (AXIAL)	
C561	CZSL1H470J	C CERA	50V SL 47PF J (AXIAL)	
C562	CZSL1H470J	C CERA	50V SL 47PF J (AXIAL)	
C563	CZSL1H470J	C CERA	50V SL 47PF J (AXIAL)	
C564	CZSL1H360J	C CERA	50V SL 36PF J (AXIAL)	
C565	CZSL1H360J	C CERA	50V SL 36PF J (AXIAL)	
C567	CZSL1H360J	C CERA	50V SL 36PF J (AXIAL)	
C568	CBZF1H104Z	C CERA SEMI	50V F 0.1MF Z (AXIAL)	
C571	CCZF1E103Z	C CERA	25V F 0.01MF Z (AXIAL)	
C572	CCZF1E103Z	C CERA	25V F 0.01MF Z (AXIAL)	
C573	CCZF1E103Z	C CERA	25V F 0.01MF Z (AXIAL)	
C616	CCZB1H102K	C CERA	50V B 1000PF K (AXIAL)	
C705	CBZF1H104Z	C CERA SEMI	50V F 0.1MF Z (AXIAL)	
C706	CZSL1H390J	C CERA	50V SL 39PF J (AXIAL)	
C707	CZSL1H220J	C CERA	50V SL 22PF J (AXIAL)	
C708	CZSL1H220J	C CERA	50V SL 22PF J (AXIAL)	
C709	CZSL1H220J	C CERA	50V SL 22PF J (AXIAL)	
C719	CBZF1H104Z	C CERA SEMI	50V F 0.1MF Z (AXIAL)	
C721	CCZB1H271K	C CERA	50V B 270PF K (AXIAL)	
C761	CCZB1H820K	C CERA	50V B 82PF K (AXIAL)	
C762	CCZB1H820K	C CERA	50V B 82PF K (AXIAL)	
C763	CCZB1H820K	C CERA	50V B 82PF K (AXIAL)	
C770	CCZB1H471K	C CERA	50V B 470PF K (AXIAL)	
C953	CCZB1H221K	C CERA	50V B 220PF K (AXIAL)	
C954	CCZB1H271K	C CERA	50V B 270PF K (AXIAL)	
C955	CCZB1H221K	C CERA	50V B 220PF K (AXIAL)	
C956	CCZB1H271K	C CERA	50V B 270PF K (AXIAL)	
C957	CCZB1H221K	C CERA	50V B 220PF K (AXIAL)	
C958	CCZB1H271K	C CERA	50V B 270PF K (AXIAL)	
CA01	CBZR1C472M	C CERA	16V Y5R 4700PF M (AXIAL)	
CV02	CCZB1H820K	C CERA	50V B 82PF K (AXIAL)	
CV03	CBZF1H104Z	C CERA SEMI	50V F 0.1MF Z (AXIAL)	
D101	DUZ5R1BM--	DIODE ZENER	UZ-5.1BM	
D201	DBYV95C---	DIODE	BYV95C (TAPPING)	
D301	DBYV95C---	DIODE	BYV95C (TAPPING)	
D302	D1N4003---	DIODE	1N4003 (TAPPING)	
D401	DBYV95C---	DIODE	BYV95C (TAPPING)	
D402	DUZ9R1BM--	DIODE ZENER	UZ-9.1BM	
D404	D1N4148---	DIODE	1N4148 (TAPPING)	
D503	D1N4148---	DIODE	1N4148 (TAPPING)	
D504	D1N4148---	DIODE	1N4148 (TAPPING)	
D505	D1N4148---	DIODE	1N4148 (TAPPING)	
D506	D1N4148---	DIODE	1N4148 (TAPPING)	
D507	D1N4148---	DIODE	1N4148 (TAPPING)	
D508	D1N4148---	DIODE	1N4148 (TAPPING)	
D511	D1N4148---	DIODE	1N4148 (TAPPING)	
D512	D1N4148---	DIODE	1N4148 (TAPPING)	
D513	D1N4148---	DIODE	1N4148 (TAPPING)	
D601	D1N4148---	DIODE	1N4148 (TAPPING)	
D702	DUZ12BM---	DIODE ZENER	UZ-12BM	
D703	DUZ3R9B---	DIODE ZENER	UZ-3.9B	
D704	D1N4148---	DIODE	1N4148 (TAPPING)	
D705	D1N4148---	DIODE	1N4148 (TAPPING)	
D706	D1N4148---	DIODE	1N4148 (TAPPING)	
D707	D1N4148---	DIODE	1N4148 (TAPPING)	

LOC.	PART-CODE	PART-NAME	PART-DESCRIPTION	REMARK
D713	D1N4148---	DIODE	1N4148 (TAPPING)	
D714	D1N4148---	DIODE	1N4148 (TAPPING)	
D715	D1N4148---	DIODE	1N4148 (TAPPING)	
D717	D1N4148---	DIODE	1N4148 (TAPPING)	
D719	D1N4148---	DIODE	1N4148 (TAPPING)	
D720	D1N4148---	DIODE	1N4148 (TAPPING)	
D802	DBYV95C---	DIODE	BYV95C (TAPPING)	
D803	DBYV95C---	DIODE	BYV95C (TAPPING)	
D804	DBYV95C---	DIODE	BYV95C (TAPPING)	
D805	DBYV95C---	DIODE	BYV95C (TAPPING)	
D806	DBYV95C---	DIODE	BYV95C (TAPPING)	
D807	DBYV95C---	DIODE	BYV95C (TAPPING)	
D808	DBYV95C---	DIODE	BYV95C (TAPPING)	
D809	DBYV95C---	DIODE	BYV95C (TAPPING)	
D812	D1N4148---	DIODE	1N4148 (TAPPING)	
D813	DUZ9R1BM--	DIODE ZENER	UZ-9.1BM	
D814	D1N4148---	DIODE	1N4148 (TAPPING)	
D815	DUZ22BM---	DIODE ZENER	UZ-22BM	
D825	D1N4148---	DIODE	1N4148 (TAPPING)	
D960	D1N4148---	DIODE	1N4148 (TAPPING)	
DV01	D1N4148---	DIODE	1N4148 (TAPPING)	
J002	85801065GY	WIRE COPPER	AWG22 1/0.65 TIN COATING	
J003	85801065GY	WIRE COPPER	AWG22 1/0.65 TIN COATING	
J004	85801065GY	WIRE COPPER	AWG22 1/0.65 TIN COATING	
J006	85801065GY	WIRE COPPER	AWG22 1/0.65 TIN COATING	
J007	85801065GY	WIRE COPPER	AWG22 1/0.65 TIN COATING	
J008	85801065GY	WIRE COPPER	AWG22 1/0.65 TIN COATING	
J009	85801065GY	WIRE COPPER	AWG22 1/0.65 TIN COATING	
J010	85801065GY	WIRE COPPER	AWG22 1/0.65 TIN COATING	
J011	85801065GY	WIRE COPPER	AWG22 1/0.65 TIN COATING	
J012	85801065GY	WIRE COPPER	AWG22 1/0.65 TIN COATING	
J013	85801065GY	WIRE COPPER	AWG22 1/0.65 TIN COATING	
J014	85801065GY	WIRE COPPER	AWG22 1/0.65 TIN COATING	
J016	85801065GY	WIRE COPPER	AWG22 1/0.65 TIN COATING	
J017	85801065GY	WIRE COPPER	AWG22 1/0.65 TIN COATING	
J018	85801065GY	WIRE COPPER	AWG22 1/0.65 TIN COATING	
J020	85801065GY	WIRE COPPER	AWG22 1/0.65 TIN COATING	
J021	85801065GY	WIRE COPPER	AWG22 1/0.65 TIN COATING	
J022	85801065GY	WIRE COPPER	AWG22 1/0.65 TIN COATING	
J023	85801065GY	WIRE COPPER	AWG22 1/0.65 TIN COATING	
J024	85801065GY	WIRE COPPER	AWG22 1/0.65 TIN COATING	
J025	85801065GY	WIRE COPPER	AWG22 1/0.65 TIN COATING	
J026	85801065GY	WIRE COPPER	AWG22 1/0.65 TIN COATING	
J027	85801065GY	WIRE COPPER	AWG22 1/0.65 TIN COATING	
J028	85801065GY	WIRE COPPER	AWG22 1/0.65 TIN COATING	
J030	85801065GY	WIRE COPPER	AWG22 1/0.65 TIN COATING	
J031	85801065GY	WIRE COPPER	AWG22 1/0.65 TIN COATING	
J032	85801065GY	WIRE COPPER	AWG22 1/0.65 TIN COATING	
J033	85801065GY	WIRE COPPER	AWG22 1/0.65 TIN COATING	
J034	85801065GY	WIRE COPPER	AWG22 1/0.65 TIN COATING	
J035	85801065GY	WIRE COPPER	AWG22 1/0.65 TIN COATING	
J037	85801065GY	WIRE COPPER	AWG22 1/0.65 TIN COATING	
J038	85801065GY	WIRE COPPER	AWG22 1/0.65 TIN COATING	
J039	85801065GY	WIRE COPPER	AWG22 1/0.65 TIN COATING	
J040	85801065GY	WIRE COPPER	AWG22 1/0.65 TIN COATING	
J041	85801065GY	WIRE COPPER	AWG22 1/0.65 TIN COATING	
J042	85801065GY	WIRE COPPER	AWG22 1/0.65 TIN COATING	
J043	85801065GY	WIRE COPPER	AWG22 1/0.65 TIN COATING	
J044	85801065GY	WIRE COPPER	AWG22 1/0.65 TIN COATING	
J045	85801065GY	WIRE COPPER	AWG22 1/0.65 TIN COATING	
J046	85801065GY	WIRE COPPER	AWG22 1/0.65 TIN COATING	
J048	85801065GY	WIRE COPPER	AWG22 1/0.65 TIN COATING	

[illegible]

LOC.	PART-CODE	PART-NAME	PART-DESCRIPTION	REMARK
J133	85801065GY	WIRE COPPER	AWG22 1/0.65 TIN COATING	
J134	85801065GY	WIRE COPPER	AWG22 1/0.65 TIN COATING	
J135	85801065GY	WIRE COPPER	AWG22 1/0.65 TIN COATING	
J136	85801065GY	WIRE COPPER	AWG22 1/0.65 TIN COATING	
J137	85801065GY	WIRE COPPER	AWG22 1/0.65 TIN COATING	
J138	85801065GY	WIRE COPPER	AWG22 1/0.65 TIN COATING	
J139	85801065GY	WIRE COPPER	AWG22 1/0.65 TIN COATING	
J141	85801065GY	WIRE COPPER	AWG22 1/0.65 TIN COATING	
J142	85801065GY	WIRE COPPER	AWG22 1/0.65 TIN COATING	
J144	85801065GY	WIRE COPPER	AWG22 1/0.65 TIN COATING	
J145	85801065GY	WIRE COPPER	AWG22 1/0.65 TIN COATING	
J146	85801065GY	WIRE COPPER	AWG22 1/0.65 TIN COATING	
J147	85801065GY	WIRE COPPER	AWG22 1/0.65 TIN COATING	
J148	85801065GY	WIRE COPPER	AWG22 1/0.65 TIN COATING	
J149	85801065GY	WIRE COPPER	AWG22 1/0.65 TIN COATING	
J151	85801065GY	WIRE COPPER	AWG22 1/0.65 TIN COATING	
J152	85801065GY	WIRE COPPER	AWG22 1/0.65 TIN COATING	
J153	85801065GY	WIRE COPPER	AWG22 1/0.65 TIN COATING	
J159	85801065GY	WIRE COPPER	AWG22 1/0.65 TIN COATING	
J161	85801065GY	WIRE COPPER	AWG22 1/0.65 TIN COATING	
J163	85801065GY	WIRE COPPER	AWG22 1/0.65 TIN COATING	
J164	85801065GY	WIRE COPPER	AWG22 1/0.65 TIN COATING	
J165	85801065GY	WIRE COPPER	AWG22 1/0.65 TIN COATING	
J166	85801065GY	WIRE COPPER	AWG22 1/0.65 TIN COATING	
J167	85801065GY	WIRE COPPER	AWG22 1/0.65 TIN COATING	
J168	85801065GY	WIRE COPPER	AWG22 1/0.65 TIN COATING	
J169	85801065GY	WIRE COPPER	AWG22 1/0.65 TIN COATING	
J170	85801065GY	WIRE COPPER	AWG22 1/0.65 TIN COATING	
J171	85801065GY	WIRE COPPER	AWG22 1/0.65 TIN COATING	
J172	85801065GY	WIRE COPPER	AWG22 1/0.65 TIN COATING	
J174	85801065GY	WIRE COPPER	AWG22 1/0.65 TIN COATING	
J175	85801065GY	WIRE COPPER	AWG22 1/0.65 TIN COATING	
J178	85801065GY	WIRE COPPER	AWG22 1/0.65 TIN COATING	
J179	85801065GY	WIRE COPPER	AWG22 1/0.65 TIN COATING	
J183	85801065GY	WIRE COPPER	AWG22 1/0.65 TIN COATING	
J185	85801065GY	WIRE COPPER	AWG22 1/0.65 TIN COATING	
L101	5CPZ568M02	COIL PEAKING	0.56UH M (AXIAL 3.5MM)	
L108	5CPZ150K02	COIL PEAKING	15UH K (AXIAL 3.5MM)	
L109	5CPZ150K02	COIL PEAKING	15UH K (AXIAL 3.5MM)	
L501	5CPZ330K02	COIL PEAKING	33UH K (AXIAL 3.5MM)	
L502	5CPZ100K02	COIL PEAKING	10UH K (AXIAL 3.5MM)	
L503	5CPZ829K02	COIL PEAKING	8.2UH K (AXIAL 3.5MM)	
L504	5CPZ150K02	COIL PEAKING	15UH K (AXIAL 3.5MM)	
L505	5CPZ150K02	COIL PEAKING	15UH K (AXIAL 3.5MM)	
L506	5CPZ120K02	COIL PEAKING	12UH K (AXIAL 3.5MM)	
L701	5CPZ330K02	COIL PEAKING	33UH K (AXIAL 3.5MM)	
L702	5CPZ560K02	COIL PEAKING	56UH K (AXIAL 3.5MM)	
L705	5CPZ569K02	COIL PEAKING	5.6UH K (AXIAL 3.5MM)	
L706	5CPZ569K02	COIL PEAKING	5.6UH K (AXIAL 3.5MM)	
L707	5CPZ569K02	COIL PEAKING	5.6UH K (AXIAL 3.5MM)	
L708	5CPZ569K02	COIL PEAKING	5.6UH K (AXIAL 3.5MM)	
R101	RD-AZ101J-	R CARBON FILM	1/6 100 OHM J	
R102	RD-AZ331J-	R CARBON FILM	1/6 330 OHM J	
R103	RD-AZ562J-	R CARBON FILM	1/6 5.6K OHM J	
R104	RD-AZ431J-	R CARBON FILM	1/6 430 OHM J	
R105	RD-AZ152J-	R CARBON FILM	1/6 1.5K OHM J	
R106	RD-AZ330J-	R CARBON FILM	1/6 33 OHM J	
R107	RD-AZ102J-	R CARBON FILM	1/6 1K OHM J	
R108	RD-AZ182J-	R CARBON FILM	1/6 1.8K OHM J	
R110	RD-AZ104J-	R CARBON FILM	1/6 100K OHM J	
R111	RD-AZ124J-	R CARBON FILM	1/6 120K OHM J	
R112	RD-AZ222J-	R CARBON FILM	1/6 2.2K OHM J	

LOC.	PART-CODE	PART-NAME	PART-DESCRIPTION	REMARK
R113	RD-AZ682J-	R CARBON FILM	1/6 6.8K OHM J	
R114	RD-AZ102J-	R CARBON FILM	1/6 1K OHM J	
R115	RD-AZ162J-	R CARBON FILM	1/6 1.6K OHM J	
R116	RD-AZ202J-	R CARBON FILM	1/6 2K OHM J	
R117	RD-AZ151J-	R CARBON FILM	1/6 150 OHM J	
R118	RD-AZ102J-	R CARBON FILM	1/6 1K OHM J	
R120	RD-AZ431J-	R CARBON FILM	1/6 430 OHM J	
R121	RD-AZ102J-	R CARBON FILM	1/6 1K OHM J	
R122	RD-AZ911J-	R CARBON FILM	1/6 910 OHM J	
R123	RD-AZ332J-	R CARBON FILM	1/6 3.3K OHM J	
R124	RD-AZ560J-	R CARBON FILM	1/6 56 OHM J	
R125	RD-AZ102J-	R CARBON FILM	1/6 1K OHM J	
R301	RD-AZ102J-	R CARBON FILM	1/6 1K OHM J	
R302	RD-AZ273J-	R CARBON FILM	1/6 27K OHM J	
R303	RD-AZ333J-	R CARBON FILM	1/6 33K OHM J	
R304	RD-AZ333J-	R CARBON FILM	1/6 33K OHM J	
R305	RD-AZ473J-	R CARBON FILM	1/6 47K OHM J	
R306	RD-AZ561J-	R CARBON FILM	1/6 560 OHM J	
R308	RD-AZ393J-	R CARBON FILM	1/6 39K OHM J	
R310	RD-2Z391J-	R CARBON FILM	1/2 390 OHM J	
R311	RD-AZ332J-	R CARBON FILM	1/6 3.3K OHM J	
R312	RD-AZ363J-	R CARBON FILM	1/6 36K OHM J	
R313	RD-AZ683J-	R CARBON FILM	1/6 68K OHM J	
R314	RD-AZ103J-	R CARBON FILM	1/6 10K OHM J	
R316	RD-AZ222J-	R CARBON FILM	1/6 2.2K OHM J	
R317	RD-AZ822J-	R CARBON FILM	1/6 8.2K OHM J	
R401	RD-AZ431J-	R CARBON FILM	1/6 430 OHM J	
R402	RD-AZ201J-	R CARBON FILM	1/6 200 OHM J	
R403	RD-4Z432J-	R CARBON FILM	1/4 4.3K OHM J	
R407	RD-AZ103J-	R CARBON FILM	1/6 10K OHM J	
R408	RD-AZ431J-	R CARBON FILM	1/6 430 OHM J	
R409	RD-AZ332J-	R CARBON FILM	1/6 3.3K OHM J	
R411	RD-2Z562J-	R CARBON FILM	1/2 5.6K OHM J	
R412	RD-AZ103J-	R CARBON FILM	1/6 10K OHM J	
R413	RD-4Z304J-	R CARBON FILM	L 1/4 300K OHM J	14"
R413	RD-4Z244J-	R CARBON FILM	1/4 240K OHM J	20"
R414	RD-4Z304J-	R CARBON FILM	L 1/4 300K OHM J	14"
R414	RD-4Z244J-	R CARBON FILM	1/4 240K OHM J	20"
R415	RD-2Z752J-	R CARBON FILM	1/2 7.5K OHM J	
R416	RD-4Z512J-	R CARBON FILM	1/4 5.1K OHM J	
R417	RD-AZ204J-	R CARBON FILM	1/6 200K OHM J	
R501	RD-AZ564J-	R CARBON FILM	1/6 560K OHM J	
R503	RD-AZ753J-	R CARBON FILM	1/6 75K OHM J	
R504	RD-AZ222J-	R CARBON FILM	1/6 2.2K OHM J	
R505	RD-AZ561J-	R CARBON FILM	1/6 560 OHM J	
R506	RD-AZ561J-	R CARBON FILM	1/6 560 OHM J	
R508	RD-AZ473J-	R CARBON FILM	1/6 47K OHM J	
R509	RD-AZ473J-	R CARBON FILM	1/6 47K OHM J	
R510	RD-AZ473J-	R CARBON FILM	1/6 47K OHM J	
R511	RD-AZ473J-	R CARBON FILM	1/6 47K OHM J	
R512	RD-AZ472J-	R CARBON FILM	1/6 4.7K OHM J	
R513	RD-AZ472J-	R CARBON FILM	1/6 4.7K OHM J	
R514	RD-AZ561J-	R CARBON FILM	1/6 560 OHM J	
R515	RD-AZ561J-	R CARBON FILM	1/6 560 OHM J	
R516	RD-AZ222J-	R CARBON FILM	1/6 2.2K OHM J	
R517	RD-AZ472J-	R CARBON FILM	1/6 4.7K OHM J	
R518	RD-AZ472J-	R CARBON FILM	1/6 4.7K OHM J	
R519	RD-AZ103J-	R CARBON FILM	1/6 10K OHM J	
R526	RD-AZ103J-	R CARBON FILM	1/6 10K OHM J	
R527	RD-AZ622J-	R CARBON FILM	1/6 6.2K OHM J	
R528	RD-AZ183J-	R CARBON FILM	1/6 18K OHM J	
R529	RD-AZ132J-	R CARBON FILM	1/6 1.3K OHM J	

LOC.	PART-CODE	PART-NAME	PART-DESCRIPTION	REMARK
R530	RD-AZ132J-	R CARBON FILM	1/6 1.3K OHM J	14" 20"
R531	RD-AZ152J-	R CARBON FILM	1/6 1.5K OHM J	
R532	RD-AZ102J-	R CARBON FILM	1/6 1K OHM J	
R533	RD-AZ203J-	R CARBON FILM	1/6 20K OHM J	
R534	RD-AZ102J-	R CARBON FILM	1/6 1K OHM J	
R535	RD-AZ473J-	R CARBON FILM	1/6 47K OHM J	
R536	RD-AZ473J-	R CARBON FILM	1/6 47K OHM J	
R541	RD-AZ333J-	R CARBON FILM	1/6 33K OHM J	
R546	RD-AZ242J-	R CARBON FILM	1/6 2.4K OHM J	
R547	RD-AZ152J-	R CARBON FILM	1/6 1.5K OHM J	
R548	RD-AZ223J-	R CARBON FILM	1/6 22K OHM J	
R549	RD-AZ683J-	R CARBON FILM	1/6 68K OHM J	
R550	RD-AZ472J-	R CARBON FILM	1/6 4.7K OHM J	
R551	RD-AZ203J-	R CARBON FILM	1/6 20K OHM J	
R552	RD-AZ222J-	R CARBON FILM	1/6 2.2K OHM J	
R553	RD-AZ623J-	R CARBON FILM	P 1/6 62K OHM J	
R553	RD-AZ753J-	R CARBON FILM	1/6 75K OHM J	
R554	RD-AZ392J-	R CARBON FILM	1/6 3.9K OHM J	
R556	RD-AZ105J-	R CARBON FILM	1/6 1M OHM J	
R561	RD-AZ122J-	R CARBON FILM	1/6 1.2K OHM J	
R562	RD-AZ122J-	R CARBON FILM	1/6 1.2K OHM J	
R563	RD-AZ122J-	R CARBON FILM	1/6 1.2K OHM J	
R564	RD-AZ302J-	R CARBON FILM	1/6 3K OHM J	
R565	RD-AZ302J-	R CARBON FILM	1/6 3K OHM J	
R566	RD-AZ302J-	R CARBON FILM	1/6 3K OHM J	
R567	RD-AZ103J-	R CARBON FILM	1/6 10K OHM J	
R568	RD-AZ332J-	R CARBON FILM	1/6 3.3K OHM J	
R570	RD-AZ332J-	R CARBON FILM	1/6 3.3K OHM J	
R573	RD-AZ332J-	R CARBON FILM	1/6 3.3K OHM J	
R580	RD-AZ183J-	R CARBON FILM	1/6 18K OHM J	
R605	RD-AZ472J-	R CARBON FILM	1/6 4.7K OHM J	
R606	RD-AZ244J-	R CARBON FILM	1/6 240K OHM J	
R607	RD-AZ272J-	R CARBON FILM	1/6 2.7K OHM J	
R608	RD-4Z430J-	R CARBON FILM	1/4 43 OHM J	
R609	RD-2Z223J-	R CARBON FILM	1/2 22K OHM J	
R610	RD-4Z430J-	R CARBON FILM	1/4 43 OHM J	
R701	RD-4Z222J-	R CARBON FILM	1/4 2.2K OHM J	
R704	RD-AZ473J-	R CARBON FILM	1/6 47K OHM J	
R705	RD-AZ473J-	R CARBON FILM	1/6 47K OHM J	
R706	RD-AZ473J-	R CARBON FILM	1/6 47K OHM J	
R707	RD-AZ103J-	R CARBON FILM	1/6 10K OHM J	
R708	RD-AZ102J-	R CARBON FILM	1/6 1K OHM J	
R709	RD-AZ471J-	R CARBON FILM	1/6 470 OHM J	
R710	RD-AZ101J-	R CARBON FILM	1/6 100 OHM J	
R711	RD-AZ101J-	R CARBON FILM	1/6 100 OHM J	
R712	RD-AZ101J-	R CARBON FILM	1/6 100 OHM J	
R713	RD-AZ101J-	R CARBON FILM	1/6 100 OHM J	
R716	RD-AZ103J-	R CARBON FILM	1/6 10K OHM J	
R717	RD-AZ103J-	R CARBON FILM	1/6 10K OHM J	
R718	RD-AZ103J-	R CARBON FILM	1/6 10K OHM J	
R719	RD-AZ103J-	R CARBON FILM	1/6 10K OHM J	
R720	RD-AZ103J-	R CARBON FILM	1/6 10K OHM J	
R721	RD-AZ683J-	R CARBON FILM	1/6 68K OHM J	
R722	RD-AZ103J-	R CARBON FILM	1/6 10K OHM J	
R723	RD-AZ753J-	R CARBON FILM	1/6 75K OHM J	
R724	RD-AZ103J-	R CARBON FILM	1/6 10K OHM J	
R725	RD-AZ273J-	R CARBON FILM	1/6 27K OHM J	
R726	RD-AZ682J-	R CARBON FILM	1/6 6.8K OHM J	
R727	RD-AZ302J-	R CARBON FILM	1/6 3K OHM J	
R728	RD-AZ273J-	R CARBON FILM	1/6 27K OHM J	
R731	RD-AZ433J-	R CARBON FILM	1/6 43K OHM J	
R732	RD-AZ102J-	R CARBON FILM	1/6 1K OHM J	

LOC.	PART-CODE	PART-NAME	PART-DESCRIPTION	REMARK
R733	RD-AZ512J-	R CARBON FILM	1/6 5.1K OHM J	
R734	RD-AZ273J-	R CARBON FILM	1/6 27K OHM J	
R735	RD-AZ561J-	R CARBON FILM	1/6 560 OHM J	
R736	RD-AZ181J-	R CARBON FILM	1/6 180 OHM J	
R738	RD-AZ101J-	R CARBON FILM	1/6 100 OHM J	
R739	RD-AZ103J-	R CARBON FILM	1/6 10K OHM J	
R740	RD-AZ302J-	R CARBON FILM	1/6 3K OHM J	
R741	RD-AZ392J-	R CARBON FILM	1/6 3.9K OHM J	
R742	RD-AZ103J-	R CARBON FILM	1/6 10K OHM J	
R743	RD-AZ472J-	R CARBON FILM	1/6 4.7K OHM J	
R744	RD-AZ103J-	R CARBON FILM	1/6 10K OHM J	
R745	RD-AZ104J-	R CARBON FILM	1/6 100K OHM J	
R746	RD-AZ473J-	R CARBON FILM	1/6 47K OHM J	
R747	RD-AZ473J-	R CARBON FILM	1/6 10K OHM J	
R748	RD-AZ103J-	R CARBON FILM	1/6 10K OHM J	
R749	RD-AZ472J-	R CARBON FILM	1/6 4.7K OHM J	
R750	RD-AZ101J-	R CARBON FILM	1/6 100 OHM J	
R751	RD-AZ102J-	R CARBON FILM	1/6 1K OHM J	
R752	RD-AZ162J-	R CARBON FILM	1/6 1.6K OHM J	
R753	RD-AZ473J-	R CARBON FILM	1/6 47K OHM J	
R754	RD-AZ473J-	R CARBON FILM	1/6 47K OHM J	
R755	RD-AZ473J-	R CARBON FILM	1/6 47K OHM J	
R756	RD-AZ392J-	R CARBON FILM	1/6 3.9K OHM J	
R757	RD-AZ202J-	R CARBON FILM	1/6 2K OHM J	
R758	RD-AZ333J-	R CARBON FILM	1/6 33K OHM J	
R761	RD-AZ103J-	R CARBON FILM	1/6 10K OHM J	
R762	RD-AZ561J-	R CARBON FILM	1/6 560 OHM J	
R802	RD-4Z274J-	R CARBON FILM	1/4 270K OHM J	
R803	RD-4Z304J-	R CARBON FILM	1/4 300K OHM J	
R808	RD-4Z100J-	R CARBON FILM	1/4 10 OHM J	
R810	RD-4Z272J-	R CARBON FILM	1/4 2.7K OHM J	
R812	RD-4Z272J-	R CARBON FILM	1/4 2.7K OHM J	
R814	RC-2Z275J-	R CARBON COMP	1/2 2.7M OHM J	
R815	RC-2Z275J-	R CARBON COMP	1/2 2.7M OHM J	
R820	RD-4Z824J-	R CARBON FILM	1/4 820K OHM J	
R821	RD-4Z824J-	R CARBON FILM	1/4 820K OHM J	
R822	RD-4Z303J-	R CARBON FILM	1/4 30K OHM J	
R823	RD-AZ103J-	R CARBON FILM	1/6 10K OHM J	
R824	RD-AZ103J-	R CARBON FILM	1/6 10K OHM J	
R826	RD-AZ103J-	R CARBON FILM	1/6 10K OHM J	
R827	RD-AZ332J-	R CARBON FILM	1/6 3.3K OHM J	
R828	RD-AZ472J-	R CARBON FILM	1/6 4.7K OHM J	
R845	RD-2Z153J-	R CARBON FILM	1/2 15K OHM J	
R846	RD-4Z223J-	R CARBON FILM	1/4 22K OHM J	
R847	RD-4Z223J-	R CARBON FILM	1/4 22K OHM J	
R954	RD-AZ471J-	R CARBON FILM	1/6 470 OHM J	
R955	RD-AZ471J-	R CARBON FILM	1/6 470 OHM J	
R956	RD-AZ471J-	R CARBON FILM	1/6 470 OHM J	
R957	RD-2Z332J-	R CARBON FILM	1/2 3.3K OHM J	
R958	RD-2Z332J-	R CARBON FILM	1/2 3.3K OHM J	
R959	RD-2Z332J-	R CARBON FILM	1/2 3.3K OHM J	
R961	RD-AZ152J-	R CARBON FILM	1/6 1.5K OHM J	
R962	RD-AZ241J-	R CARBON FILM	1/6 240 OHM J	
R963	RD-AZ560J-	R CARBON FILM	1/6 56 OHM J	
R964	RD-AZ101J-	R CARBON FILM	1/6 100 OHM J	
R965	RD-AZ152J-	R CARBON FILM	1/6 1.5K OHM J	
R966	RD-AZ241J-	R CARBON FILM	1/6 240 OHM J	
R967	RD-AZ560J-	R CARBON FILM	1/6 56 OHM J	
R968	RD-AZ101J-	R CARBON FILM	1/6 100 OHM J	
R969	RD-AZ152J-	R CARBON FILM	1/6 1.5K OHM J	
R970	RD-AZ241J-	R CARBON FILM	1/6 240 OHM J	
R971	RD-AZ560J-	R CARBON FILM	1/6 56 OHM J	

LOC.	PART-CODE	PART-NAME	PART-DESCRIPTION	REMARK
R972	RD-AZ201J-	R CARBON FILM	1/6 200 OHM J	
RA01	RD-AZ622J-	R CARBON FILM	1/6 6.2K OHM J	
RA02	RD-AZ104J-	R CARBON FILM	1/6 100K OHM J	
RV01	RD-AZ750J-	R CARBON FILM	1/6 75 OHM J	
RV02	RD-AZ471J-	R CARBON FILM	1/6 470 OHM J	
RV03	RD-AZ561J-	R CARBON FILM	1/6 560 OHM J	
RV04	RD-AZ622J-	R CARBON FILM	1/6 6.2K OHM J	
RV05	RD-AZ272J-	R CARBON FILM	1/6 2.7K OHM J	
RV06	RD-AZ102J-	R CARBON FILM	1/6 1K OHM J	
RV07	RD-AZ471J-	R CARBON FILM	1/6 470 OHM J	
RV08	RD-AZ122J-	R CARBON FILM	1/6 1.2K OHM J	
RV10	RD-AZ103J-	R CARBON FILM	1/6 10K OHM J	

EXPLODED VIEW

DTH-1450FS

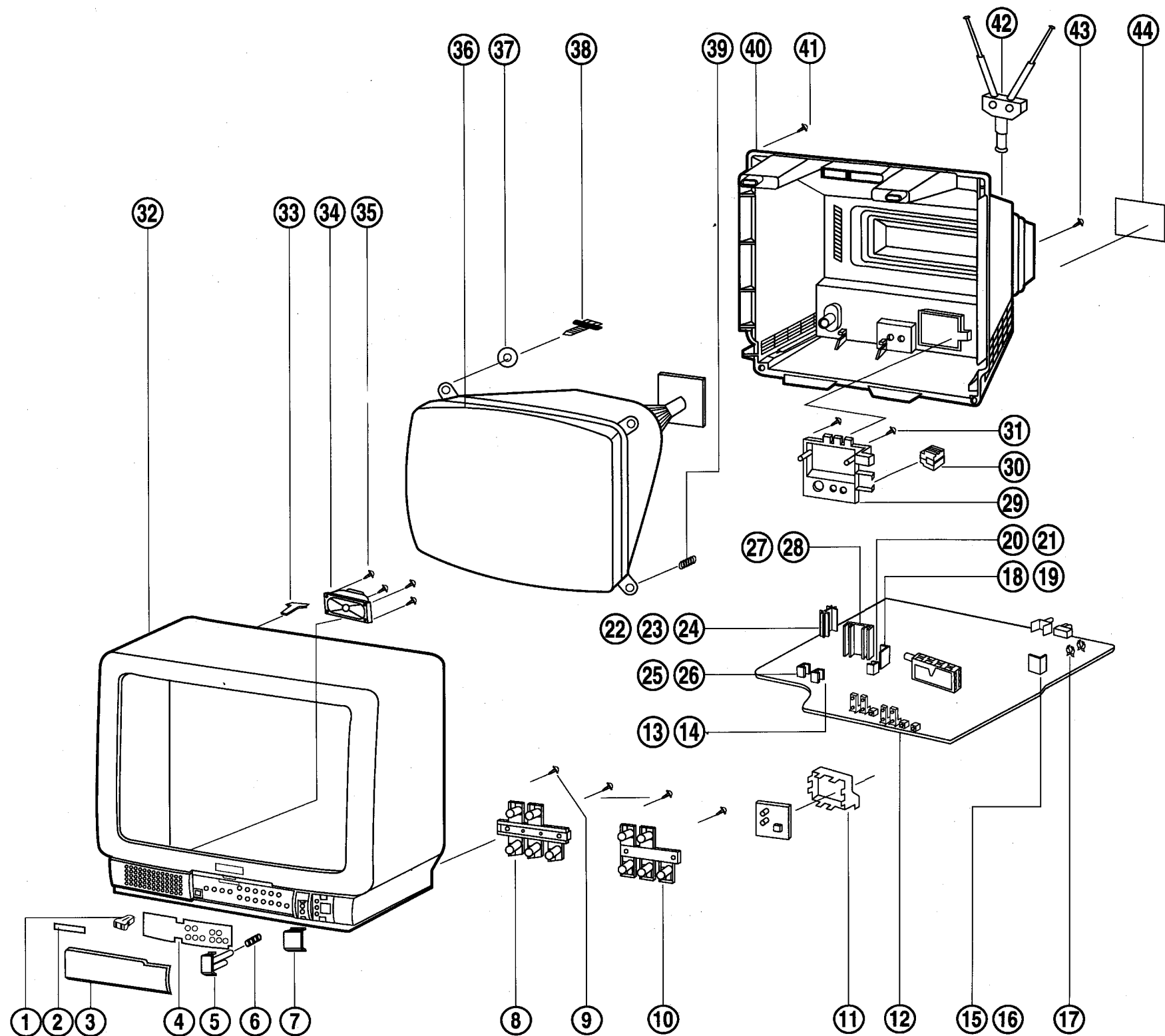

NO.	PART CODE	PART NAME	Q'TY	DESCRIPTION	REMARK
1	4857923300	DOOR LOCK	1	LA701 (KIFCO)	
2	4855613600	BRAND MARK	1	A1050P-H24 T0.4	
3	4852813501	DOOR	1	ABS BK+PAINT	
4	4855050515	DECO CTRL	1	P.C T0.3+SILK	
5	4854835501	BUTTON POWER	1	ABS BK	
6	4856716000	SPRING	1	SWPA PIE 0.5	
7	4855516301	DECO SENSOR	1	P.C SMOG T1.0	
8	4854911601	BUTTON CONTROL "B"	1	HG ABS BK	
9	7121301011	SCREW TAPPING	4	T2S PAN 3x10 MFZN	
10	4854917401	BUTTON	1	ABS BK	
11	4853734900	RETA P-AMP	1	FR HIPS BK	
12	9850137101	PCB MAIN AS	1	CM-530	
13	4857025200	HEAT SINK	1	SPCC T1.0 DG	
14	7121300811	SCREW TAPPING	1	T2S 3x8 MFZN	
15	4857013300	HEAT SINK	1	SPCC T1.0 SN-3	
16	7121300811	SCREW TAPPING	1	T2S 3x8 MFZN	
17	4857415001	CLIP FUSE	2	BSP3 SN5.2	
18	4857013300	HEAT SINK	1	SPCC T1.0 SN-3	
19	7128301011	SCREW TAPPING	1	T2S WAS 3x10 MFZN	
20	4857025200	HEAT SINK	1	SPCC T1.0 DG	
21	7121300811	SCREW TAPPING	2	T2S PAN 3x8 MFZN	
22	4857024500	HEAT SINK	1	AL EX	
23	7392300011	NUT HEX	1	6N-2-3 MFZN	
24	4856012314	SCREW SPECIAL	1	PAN 3x14 MFZN	
25	4857025200	HEAT SINK	1	SPCC T1.0 DG	
26	7121300811	SCREW TAPPING	1	PAN 3x8 MFZN	
27	4857024602	HEAT SINK	1	AL EX	
28	7121300811	SCREW TAPPING	1	T2S PAN 3x8 MFZN	
29	4853621601	TERM ANT	1	HIPS BK CORE "A"	
30	4853514400	STOPPER CORD	1	P.P BK	
31	7121401411	SCREW TAPPING	2	T2S PAN 4x14 MFZN	
32	4852044101	MASK FRONT	1	HIPS BK PAINT	
33	4853311601	RETAINER BACK	2	HIPS NC	
34	4858305220	SPEAKER	1	3W MSF-2D30SB02U	
35	7123301211	SCREW TAPPING	4	T2S PAN 3x12 MFZN	
36	48A96414N1	CRT	1	A34JLL40X	
37	4856212000	WASHER RUBBER	4	TMR CA/NF 01 BK	
38	4856212000	WASHER RUBBER	4	TMR CA/NF 01 BK	
39	4856716200	SPRING COIL	1	SUS	
40	4852129400	COVER BACK	1	FR HIPS BK	
41	7122401411	SCREW TAPPING	4	T2S TRS 4x14 MFZN	
42	4850A02510	ANT ROD	1	TS-8108B L=600MM	
43	7122401411	SCREW TAPPING	1	T2S TRS 4x14 MFZN	
44	4855415800	PLATE SPEC	1	P.C T0.3	

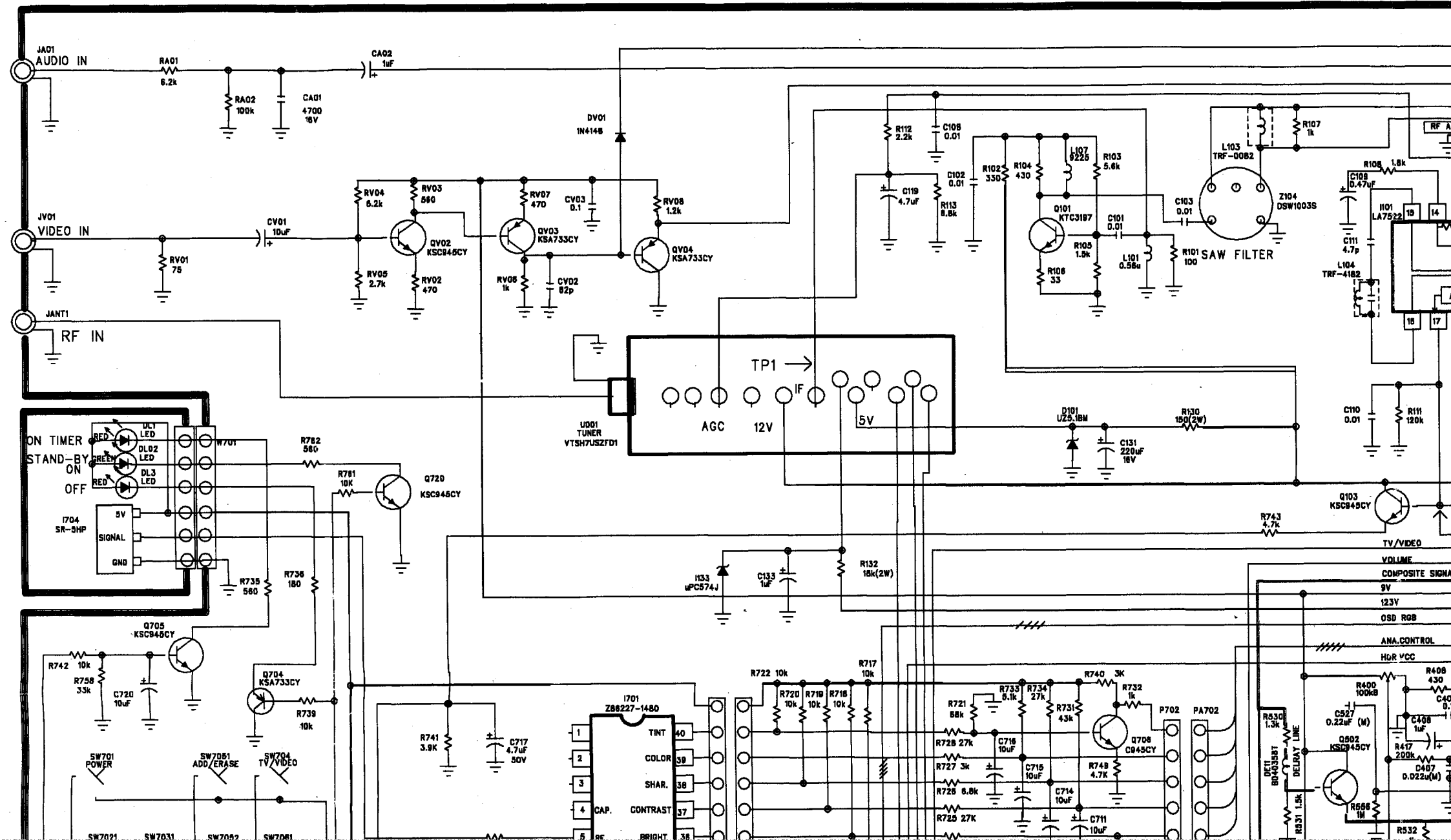

CM-530A CHASSIS^{FINAL} VERSION